

Caernarfon Suite

C1 Level, The Resort Hotel

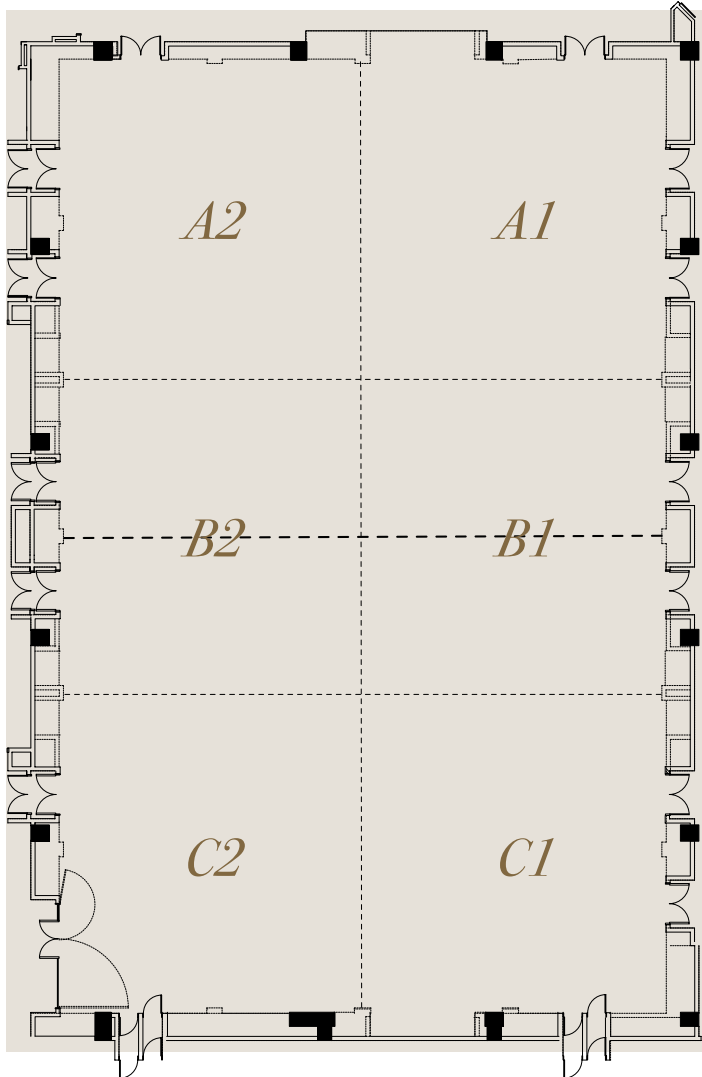

<i>Set-up</i>	<i>Capacity</i>	<i>Dimensions</i>	
U-shaped	N/A	Dimensions (Metres)	43.8x27.55
Boardroom	N/A	Square Metres	1206.7
Hollow	N/A	Dimensions (Feet)	143.7x90.39
Classroom	N/A	Square Feet	12988.7
Theatre Style	1200	Height (Metres)	6.2
Cabaret	600		
Reception	1000		
Cocktail	1500		
Dinner	900		
Dance	750		

Caernarfon Suite Half

C1 Level, The Resort Hotel

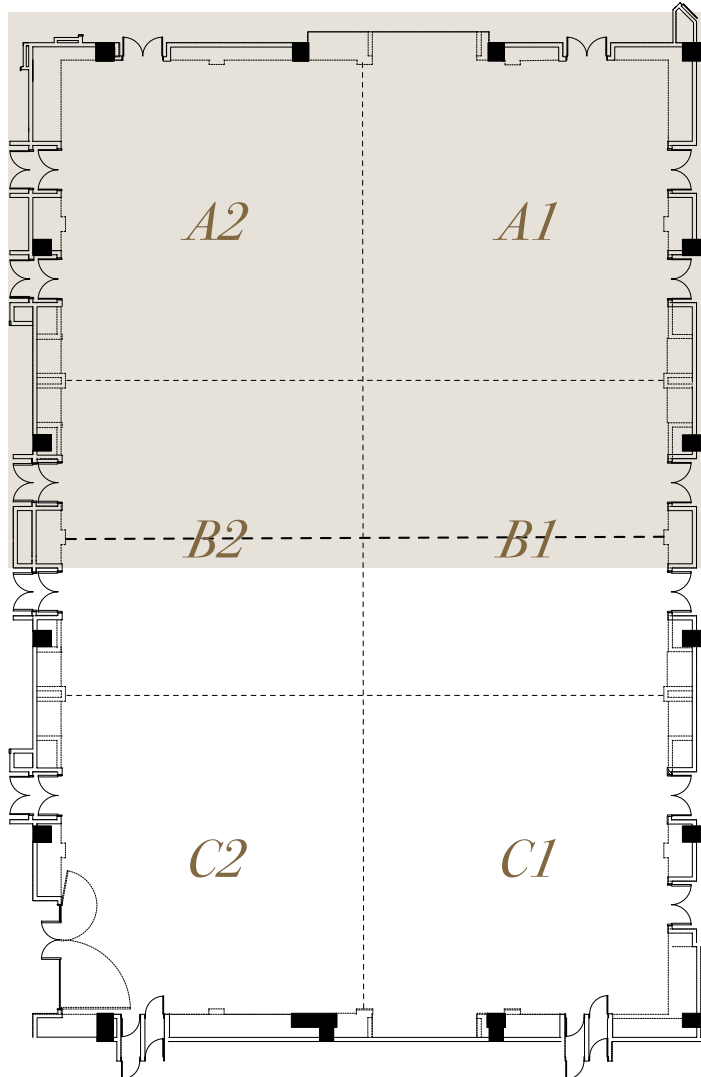

<i>Set-up</i>	<i>Capacity</i>	<i>Dimensions</i>	
U-shaped	N/A	Dimensions (Metres)	27.55x21.63
Boardroom	N/A	Square Metres	595.9
Hollow	N/A	Dimensions (Feet)	90.39x70.96
Classroom	N/A	Square Feet	6414.2
Theatre Style	600	Height (Metres)	6.2
Cabaret	320		
Reception	500		
Cocktail	700		
Dinner	500		
Dance	360		

Caernarfon Suite Third

C1 Level, The Resort Hotel

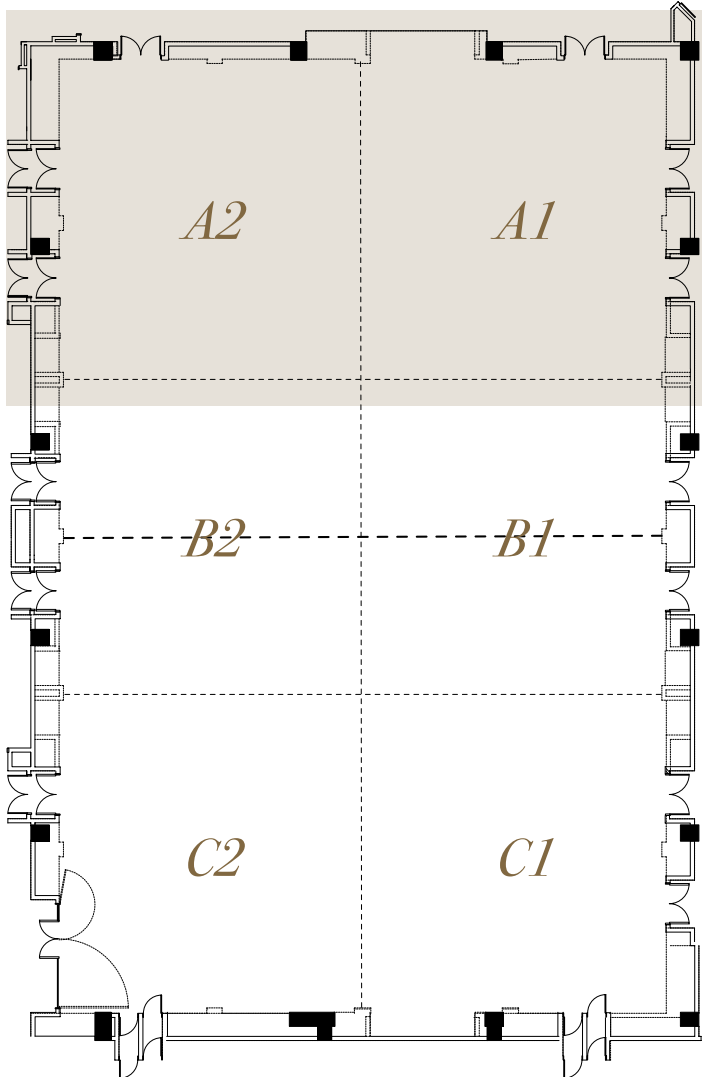

Set-up Capacity

U-shaped	N/A
Boardroom	N/A
Hollow	N/A
Classroom	N/A
Theatre Style	400
Cabaret	192
Reception	325
Cocktail	475
Dinner	220
Dance	180

Dimensions

Dimensions (Metres)	27.55x14.64
Square Metres	403.3
Dimensions (Feet)	90.39x48.03
Square Feet	4341.1
Height (Metres)	6.2

Caernarfon Suite Sixth

C1 Level, The Resort Hotel

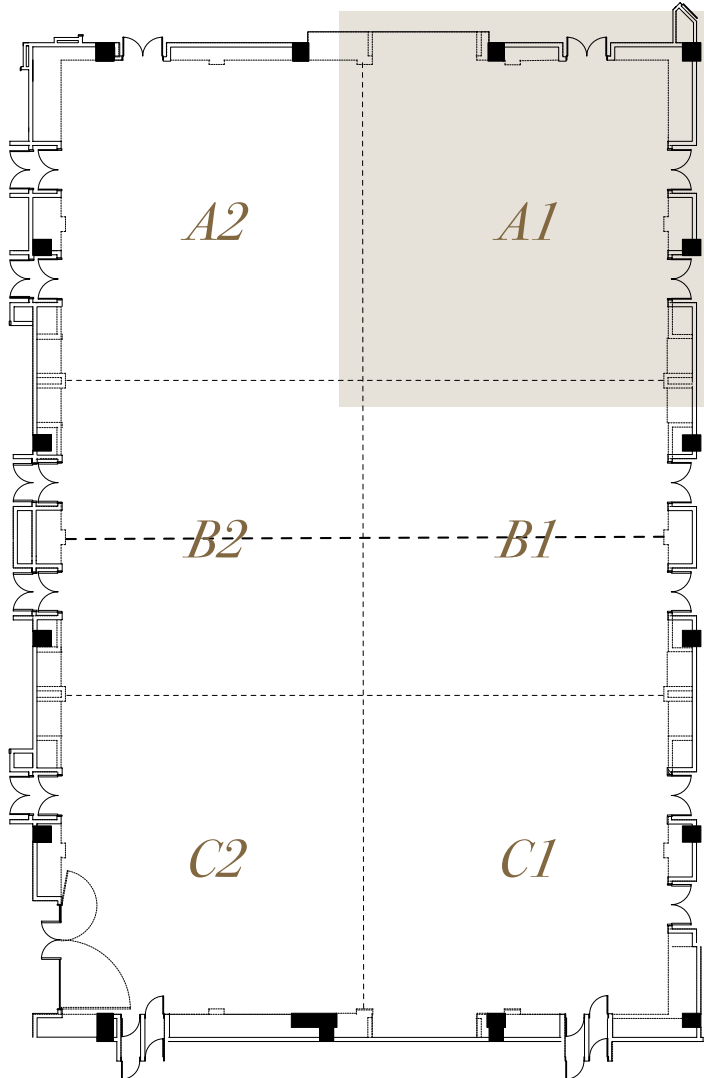

<i>Set-up</i>	<i>Capacity</i>	<i>Dimensions</i>	
U-shaped	N/A	Dimensions (Metres)	14.64x13.60
Boardroom	N/A	Square Metres	199.1
Hollow	N/A	Dimensions (Feet)	48.03x44.62
Classroom	N/A	Square Feet	2143.1
Theatre Style	200	Height (Metres)	6.2
Cabaret	96		
Reception	N/A		
Cocktail	N/A		
Dinner	N/A		
Dance	N/A		